

FORM NO 1.

Drawn 3<sup>rd</sup> Feb 1807  
for John Welsh private  
Note attached  
No 1668  
Dist 8

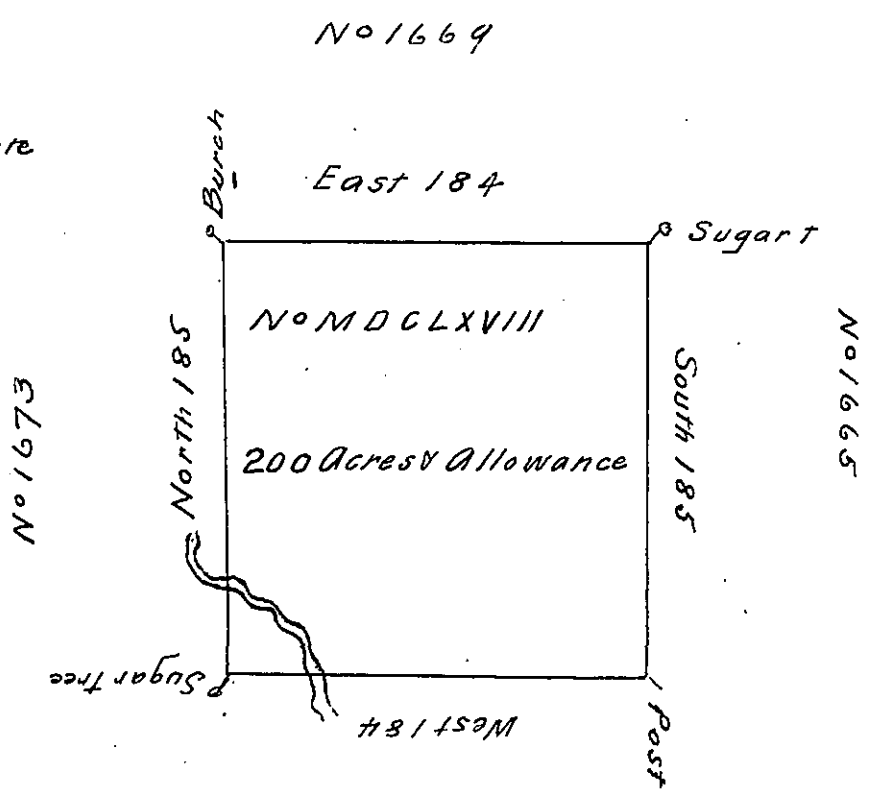

In pursuance of an Act of General Assembly  
of the State of Pennsylvania, passed the 24<sup>th</sup> day of February, 1785,  
entitled "An Act for directing the mode of distributing the Donation  
Lands promised the Troops of this Commonwealth"; and by order of  
the Surveyor General with the approbation of the Honourable the  
Supreme Executive Council, I have Surveyed on the 27<sup>th</sup> day of  
October 1785, the above described Tract of two hundred acres  
of Land, and allowance of Six per cent, for roads, &c.

No. 1668 Situate in District No. 8. on the West Side of the Allegany  
river, in the County of Westmoreland.

To John Lukens, Esq,  
Surveyor General

Alexander McDowell D.S.  
Now Crawford County

IN TESTIMONY that the above is a copy of the original remaining on file in  
the Department of Internal Affairs of Pennsylvania, made  
conformably to an Act of Assembly approved the 16th day of  
February, 1833, I have hereunto set my Hand and caused  
the Seal of said Department to be affixed at Harrisburg,  
this Twenty fifth day of August 1908

*Henry Howard*  
Secretary of Internal Affairs.